

# NORTH PART OF Mc PHERSON

• COUNTY • SEAT • OF •  
McPHERSON CO., KANSAS  
McPHERSON TOWNSHIP

Scale: 475 ft. = 1 inch  
Copyright 1921 by Geo. A. Ogle & Co.

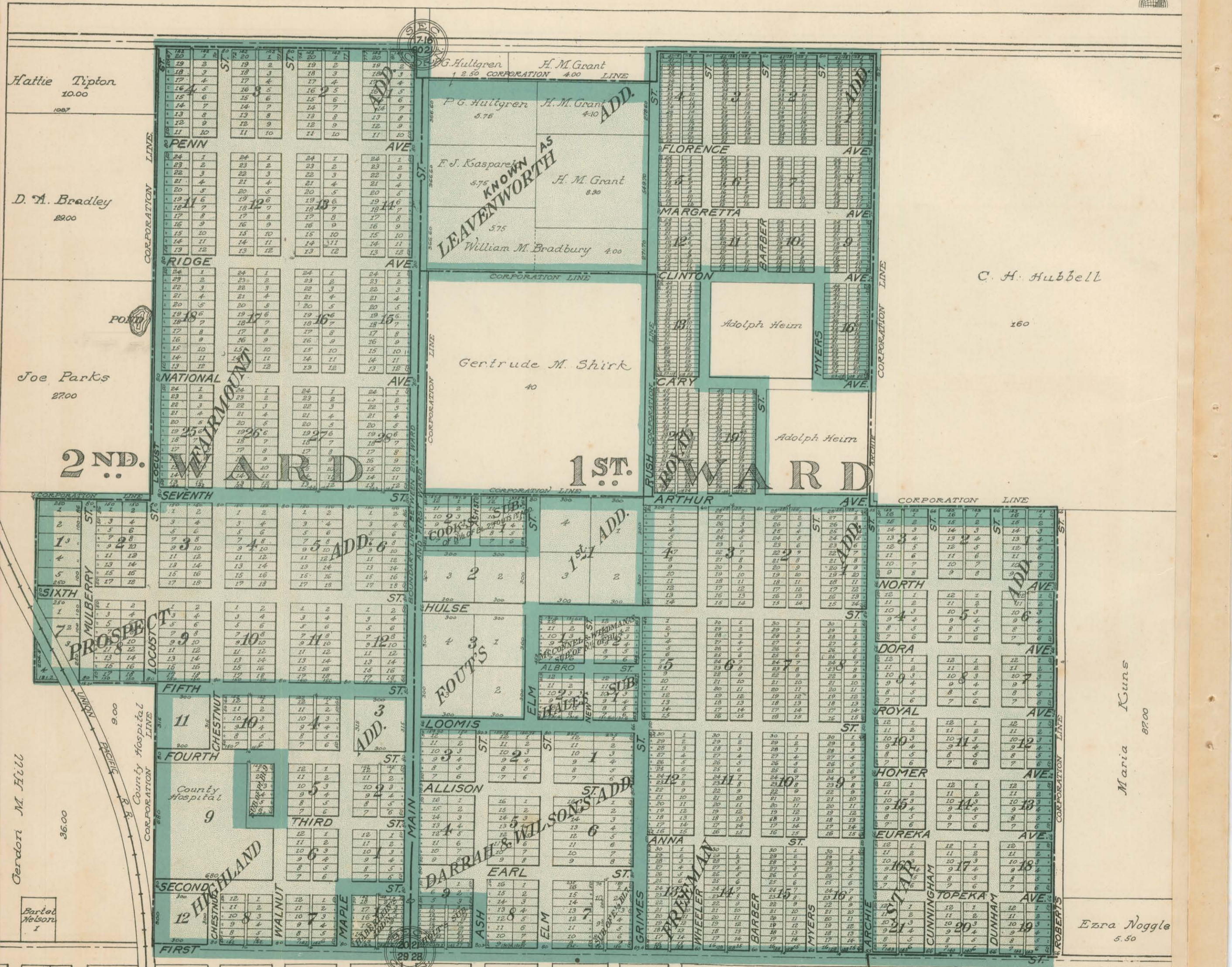

FOR SOUTH PART SEE PAGES 8 AND 9.